

2025 CALL FOR ENTRIES

Student Awards

Arizona

American Society of Landscape Architects

SUBMISSIONS DUE FRIDAY, JANUARY 10, 2025 / 4PM

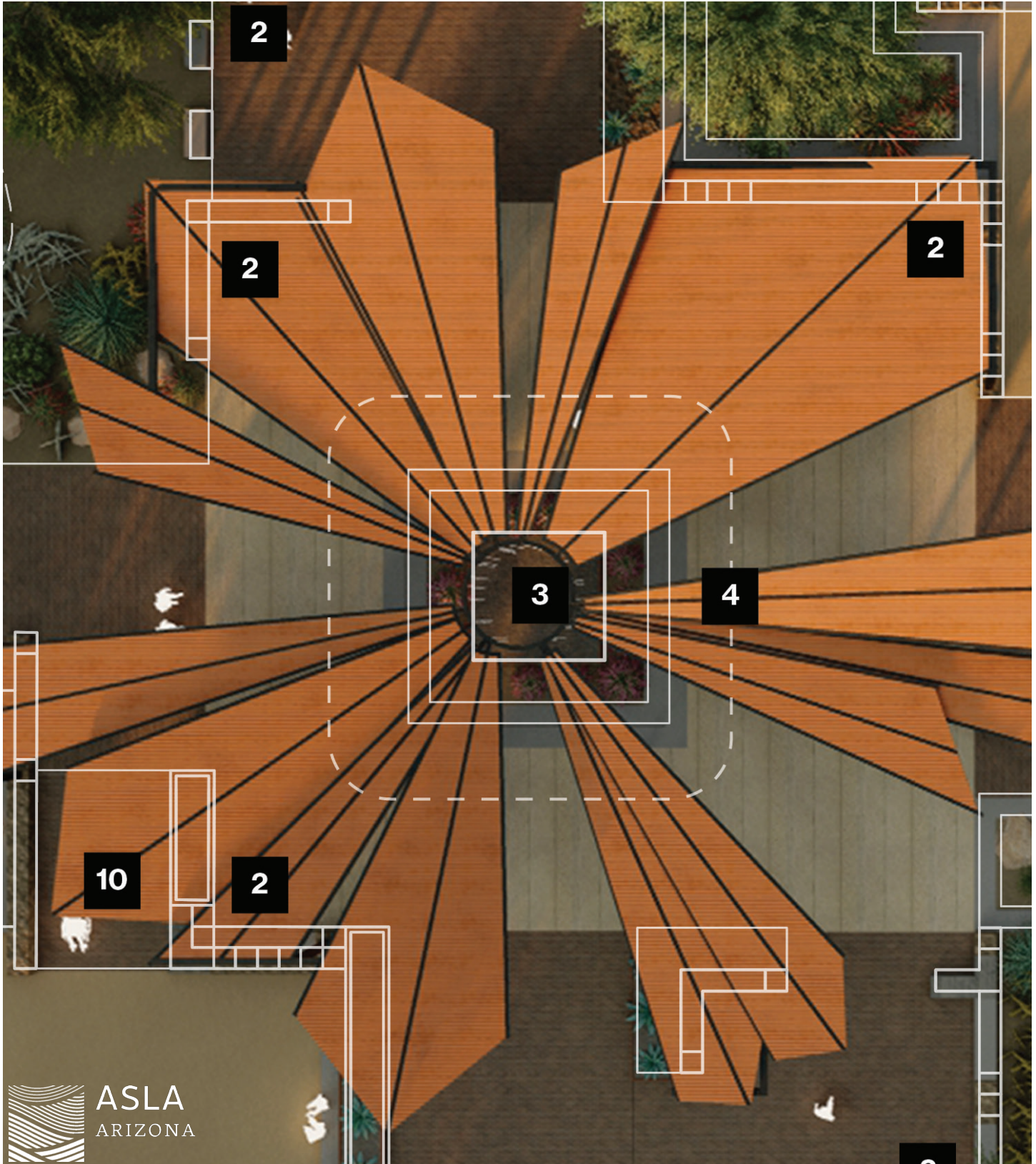

CALL FOR ENTRIES

The Arizona ASLA Awards program celebrates professional and student excellence by recognizing the firms, individuals, and agencies responsible for outstanding works of landscape architecture and environmental planning that promote an enhanced quality of life in Arizona and beyond.

DESIGN AWARDS GALA

Please join us for an evening of great food and socializing as we celebrate our design community! The 2025 Design Awards Gala will be held at **The Clayton House on Saturday, March 22**. Additional information will be emailed and posted at

www.azasla.org.

ELIGIBILITY

To enter any of the award categories, the official entrant must be a Student, Student Affiliate, International Student, or first-year Associate member of ASLA or join ASLA in one of those member categories. With the exception of the Student Collaboration Category, student entries may be individual or team efforts.

SUBMITTAL REQUIREMENTS

Projects previously submitted which have not received an award in any category are eligible for resubmission. The deadline for all entry submissions is Friday, **JANUARY 10, 2025** / 4pm - standard and/or Friday, **JANUARY 17, 2025** / 4pm - late deadline, an additional \$50.00 late fee will apply. Late entries after Friday, **JANUARY 17, 2025** / 4pm will not be accepted.

Visit us at <https://www.azasla.org/2025awardssubmittal> and follow instructions on the form.

All entries become the property of AZASLA and will be retained in the AZASLA Archives. Entrants are responsible for clearing photographs with photographers for publication and reproduction by AZASLA. AZASLA retains the right to publish photos submitted in winning entries in the Mesquite Journal Magazine, on the ASLA website, in promoting the awards program, and in other products in conjunction with promoting landscape architecture.

All questions regarding the 2025 Arizona ASLA Chapter Awards should be submitted via email to: **Karla@azasla.org**.

Winning submittals will be posted in the Mesquite Journal and on www.azasla.org

AWARDS

AWARD OF EXCELLENCE

The jury may select one overall entry that represents an award of excellence (the highest level of achievement) in each category at the discretion of the jury.

HONOR AWARD

Recognizes superior achievement in landscape architecture. Any number of honor awards in each category may be given at the discretion of the jury.

SELECTIONS & ANNOUNCEMENTS

The Professional and Student Awards Jury will review all eligible submissions and may select one Award of Excellence and any number of Honor Awards in the Individual and Collaborative categories.

Entrants will be notified of the results following the jury meetings.

The awards will be announced to the media in coordination with special coverage in Mesquite Journal and on the AZASLA website.

Recipients will be honored at the awards presentation ceremony during the AZASLA Awards Ceremony in Spring 2025.

Questions? Contact the AZASLA Honors and Awards Program Manager at **Karla@azasla.org**

WINNING STRATEGIES

What makes a submission a winner? Here are some tips for improving submissions to awards programs:

KEEP IT SIMPLE AND FOLLOW THE DIRECTIONS.

While it is tempting to customize a submission in hopes it will stand out from all the others, the best way to draw the jury's attention is through clear narrative description combined with high-quality photos and graphics. Printing out the narrative description in landscape style instead of portrait, using colored ink, or submitting a collage in order to include more images can detract from your presentation or even get the submission disqualified. Keep the focus on communicating the project's value to the jury.

FOCUS ON THE NARRATIVE DESCRIPTION.

Provide the information requested in a direct, simple style. Highlight what makes the project unique, its environmental components, its long-term value, and how it raises the bar for the profession. Resist the temptation to overwrite. Use an easily readable font—Arial is good—in at least 10-point size. Increasing line spacing from single to 1.2 and double-spacing between paragraphs makes the narrative more readable as well.

REMEMBER—PHOTOGRAPHY IS KEY.

Let's face it, the best narrative in the world cannot make up for poor photography. For design competitions, hire a professional photographer to shoot your project. Lighting is particularly important, and professional photographers can show your project to its best advantage. Be creative: Shoot the project in different seasons, during the day, and at night, if appropriate. Have the photos shot or scanned in a high-resolution (dimensions should be 3,000 pixels x 2,400 pixels, at a minimum of 300 ppi, pixels per inch) electronic format (jpeg is fairly universal). Do not submit color copies of photos; submit professionally processed photos no smaller than 8 x 10 inches.

ORGANIZE.

Do not wait until the last minute to prepare your awards submission. Maintain an awards file. Most entry requirements for awards programs are set from year to year, and changes in procedure are minimal. Gather materials early and allow plenty of time for review. Two-person proof the narrative and captions for misspellings and typos. Neatness counts.

AWARDS JURY

The 2025 Award Entries will be juried by an out of state ASLA Chapter.

COVER PHOTO

2024 Award of Excellence / Student Design

The Breakaway

Evan Sloan

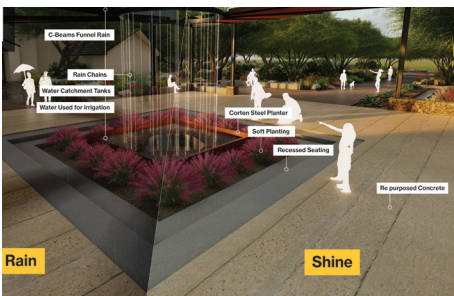

GENERAL DESIGN

RECOGNIZES: site-specific works of landscape architecture. Student entries are not required to be built.

TYPICAL ENTRIES INCLUDE: Single-site public, institutional, or private landscapes of all kinds (except entries qualifying for urban design or residential design categories); projects that include historic preservation, reclamation, or conservation; green roofs, stormwater management, sustainable design; design for transportation or infrastructure; landscape art or installation; interior landscape design; and more.

CRITERIA: The jury will consider the quality of design; design context; environmental sensitivity and sustainability; hazard mitigation, climate adaptations, and resilience strategies; and design value to the client, community, and to other designers.

PROJECT TITLE (NAME): A submission must have a short, specific presentation title (containing no abbreviations) that indicates the nature of the presentation.

PROJECT STATEMENT/NARRATIVE: Addressing the criteria for the General Design category, describe the project location, scope and size, site and context investigation, design program, design intent, materials and installation methods, environmental impact and concerns, collaboration with the client and other designers, and other significant issues. (maximum word count 350)

IMAGES*: A maximum of 16 images may be submitted with each entry having no less than 5 images uploaded. Images must include at least (1) site plan.



COLLABORATIVE

RECOGNIZES: collaborative work by landscape architecture students with students from allied or complementary disciplines. Entries are not required to be built.

TYPICAL ENTRIES INCLUDE: landscape architecture projects that meet the categories criteria of General Design, Residential Design, Analysis and Planning, Research, and Communications brought about among students from landscape architecture programs and allied and/or complementary disciplines.

CRITERIA: Projects submitted in this category must be team projects, and each team must include at least one landscape architecture student and one non-landscape architecture student. The jury will evaluate the project under the criteria outlined in the appropriate category and will also consider the demonstration of collaboration among the disciplines represented on each team.

PROJECT TITLE (NAME): A submission must have a short, specific presentation title (containing no abbreviations) that indicates the nature of the presentation.

PROJECT STATEMENT/NARRATIVE: Describe the project and why it's award-worthy. Addressing the criteria for the for the subcategory most closely fitting the entry using the category guidelines. (You will select Student Collaboration as your primary category, and note the second category using its criteria and narrative.) Also, provide a team description without using names, identify each member by field of study, level of education program, responsibilities for the project, and collaboration among team members. Pay particular attention to describing the role of the landscape architecture student(s), how landscape architecture contributed to the success of the project, what the landscape architecture student(s) learned from the other field(s) of study, and vice versa.

IMAGES*: A maximum of 16 images may be submitted with each entry having no less than 5 images uploaded. Images must include at least (1) site plan.